

# Technical data sheet

## Beam clamp TKM Chock FS



Item number: 1480850

Beam clamp for knocking in on the support with flange thicknesses of 8–20 mm.  
Suitable for parallel and inclined flanges.  
Maximum flange inclination: 14%



- St** Steel
- FS** Strip galvanized

### Master data

Item number	1480850
Type	TKM Chock 1 FS
Description 1	Beam clamp
Description 2	to knock-on
Manufacturer	OBO
Dimension	M8
Material	Steel
Surface	Strip galvanized
Surface standard	DIN EN 10346
Smallest sales unit	25
Unit of quantity	Piece
Weight	16.1 kg
Weight unit	kg/100 pc.

# Technical data sheet

## Beam clamp TKM Chock FS

Item number: 1480850



### Dimensions

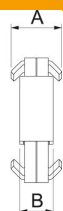
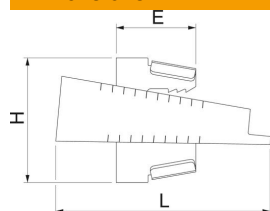

Dimension A	25 mm
Dimension B	13 mm
Dimension E	41 mm
Dimension H	61 mm
Dimension L	111 mm

### Technical data

Connection type/component	Miscellaneous
Fastening type	Clamp
Breaking load	2 kN
Flange thickness F max.	20 mm
Flange thickness F min.	8 mm
Thread metric	8
Hinge, adjustable	no
Hinged	no