

# Technical data sheet

## Hot-dip galvanised steel bend, without thread

Item number: 2046817



90° bend with moulded sleeves, for electrical installation pipes according to EN 61386-1. With burr-free inner wall.



**St** Steel

**FT** Hot-dip galvanised

### Master data

|                     |                      |
|---------------------|----------------------|
| Item number         | 2046817              |
| Type                | SBN20 FT             |
| Description 1       | Conduit plug-in bend |
| Description 2       | without thread       |
| Manufacturer        | OBO                  |
| Dimension           | Ø20mm                |
| Material            | Steel                |
| Surface             | Hot-dip galvanised   |
| Surface standard    | DIN EN ISO 1461      |
| Smallest sales unit | 25                   |
| Unit of quantity    | Piece                |
| Weight              | 13.3 kg              |
| Weight unit         | kg/100 pc.           |

# Technical data sheet

## Hot-dip galvanised steel bend, without thread

Item number: 2046817



### Dimensions

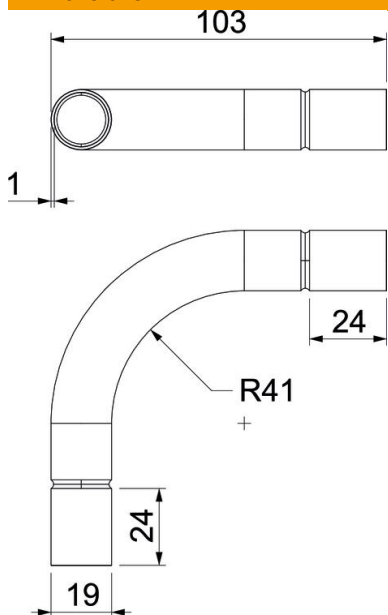

|                  |         |
|------------------|---------|
| Dimension A      | 53.7 mm |
| Dimension B      | 155 mm  |
| Dimension D      | 22.6 mm |
| Dimension d      | 20.6 mm |
| Dimension l      | 30 mm   |
| Dimension m (mm) | M20     |
| Dimension R      | 90 mm   |
| Dimension t      | 1 mm    |

### Technical data

|                                   |           |
|-----------------------------------|-----------|
| Version for                       | Connector |
| Flexible                          | no        |
| For nominal pipe diameter         | 20 mm     |
| Halogen-free                      | no        |
| With inspection opening and lid   | no        |
| With sleeve                       | yes       |
| Brushed surface                   | no        |
| Polished surface                  | no        |
| Permitted temperature range, max. | 400 °C    |
| Permitted temperature range, min. | -45 °C    |
| Angle of the bend                 | 90 °      |
| Two-part                          | no        |