

# Technical data sheet

## Cover for T branch piece DD

Item number: 7129427



Cover for tee with pre-mounted turn buckle.  
The cover can be used with fittings of all side heights.



- St** Steel
- DD** Strip galvanised zinc/aluminium, Double Dip

### Master data

Item number	7129427
Type	DFT 750 DD
Description 1	Cover, T-branch piece
Description 2	with turn buckle, for RT 750
Manufacturer	OBO
Dimension	B750mm
Material	Steel
Surface	Strip galvanised zinc/aluminium, Double Dip
Surface standard	DIN EN 10346
Smallest sales unit	1
Unit of quantity	Piece
Weight	1396 kg
Weight unit	kg/100 pc.

### Dimensions

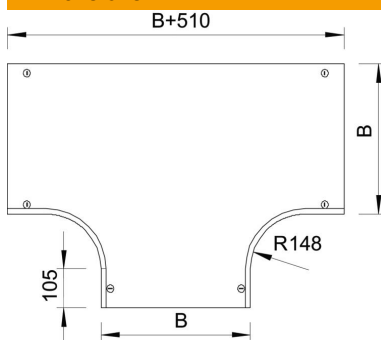

Width	750 mm
Width	30 in
Height	35 mm
Plate thickness	1.25 mm
Dimension B	750 mm
Dimension H	15 mm
Dimension R	148 mm

# Technical data sheet

## Cover for T branch piece DD

Item number: 7129427



### Technical data

Number of turn buckles	6 St.
Fastening type	Sash lock
Suitable for cable ladder	no
Suitable for cable tray	yes
Material thickness (inches)	0.05 in
Material thickness	1.25 mm
Rustproof steel, pickled	no
Wide-span version	no